

CK Series Hydraulic Chain Cutters

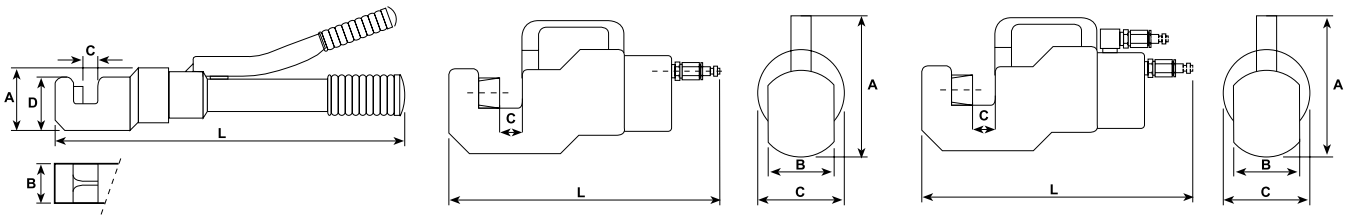

- 700 Bar
- CK0225 and CK0250 are double acting, for fast retraction
- Model with integral hand pump available
- Each tool is supplied with a light weight plastic carrying case, providing excellent tool protection and transportability



Part Number	Capacity kN	Weight Kg	A mm	B mm	C mm	D mm	L mm	Chain \varnothing max.mm.	Strength by Grades	Standards	Bar \varnothing max.mm.	Strength N/mm ²
CK0016	135	5.1	81.5	54	16	68	489	19	28 - 43 - 50	"ASTM - 413 DIN 5684"	19	700
											15	1000
								14	60 - 80	"DIN 5685 DIN 764"	13	1400
CK0116	135	4.5	81.5	54	16	68	290	19	28 - 43 - 50	"ASTM - 413 DIN 5684"	19	700
											15	1000
								14	60 - 80	"DIN 5685 DIN 764"	13	1400
CK0125	350	14	183	88	25	113	360	30	28 - 43 - 50	"ASTM - 413 DIN 5684"	30 - 25	700 - 1000
											20 - 17	1400 - 1600
								20	60 - 80	"DIN 766 DIN 762"	30 - 25	700 - 1000
CK0225	350	16	183	88	25	113	360	30	28 - 43 - 50	"ASTM - 413 DIN 5684"	30 - 25	700 - 1000
											20 - 17	1400 - 1600
								20	60 - 80	"DIN 766 DIN 762"	30 - 25	700 - 1000
CK0250	1120	80	228	120	51	206	475	50	28 - 43 - 50	DIN 5684	50 - 45	700 - 1000
											40 - 35	1400 - 1000
								40	60 - 80	DIN 685	50 - 45	700 - 1000
											40 - 35	1400 - 1000